



# Rohan Avenue

Residential Layout & Commercial Spaces

Main Road, Surathkal, Mangaluru - 575 002



## Rohan Avenue

Spread over 1.73 acres, in close proximity to the Surathkal Junction, is a plotted development with well planned roads, landscape and amenities. With over 11 Plots for sale including 23,000 sq.ft. of commercial space , 30 ft wide concrete main roads, and paved foot paths, its a perfect place to build your beautiful home and set your base for generations to come.

The site has several features like underground drainage system, rain water harvesting and power lighting among the others.

Rohan Avenue provides a comprehensive experience by amalgamating the concepts of urban and traditional lifestyles.



## Promoters



Live in a home desired by many but enjoyed by few.

Differentiating oneself from the herd requires exemplary leadership and vision. With our adherence to quality and timely delivery, we at Rohan Corporation have redefines the Real Estate sector and have dominated the skyline of Mangaluru for the past 29 years. With state-of-the-art real estate development practices, a diverse portfolio of luxurious residential apartments and planned layouts, we have built a reputation for quality and reliability.

At Rohan Corporation, we focus on modern design with distinct architecture and world-class amenities for gracious living. We don't just build building, but also lifestyles! Our projects are aesthetically Vaastu compliant and innovative, helping you build your dream home into reality.

With over 24 greatly appreciated projects, Rohan Corporation has successfully delivered great value to its clients, winning the smiles of over 2000 happy families in the process. With utmost dedication, we strive to work towards improving our quality and designs with every project. We earnestly hope to add to the architectural refinement of this charming coastal city of Mangaluru.



Site No	Area in Cents
01	.....
02	5.16
03	5.16
04	5.16
05	5.16
06	5.16
07	5.16
08	5.16
09	5.16
10	6.17
11	6.17



# Commercial Floor Plan

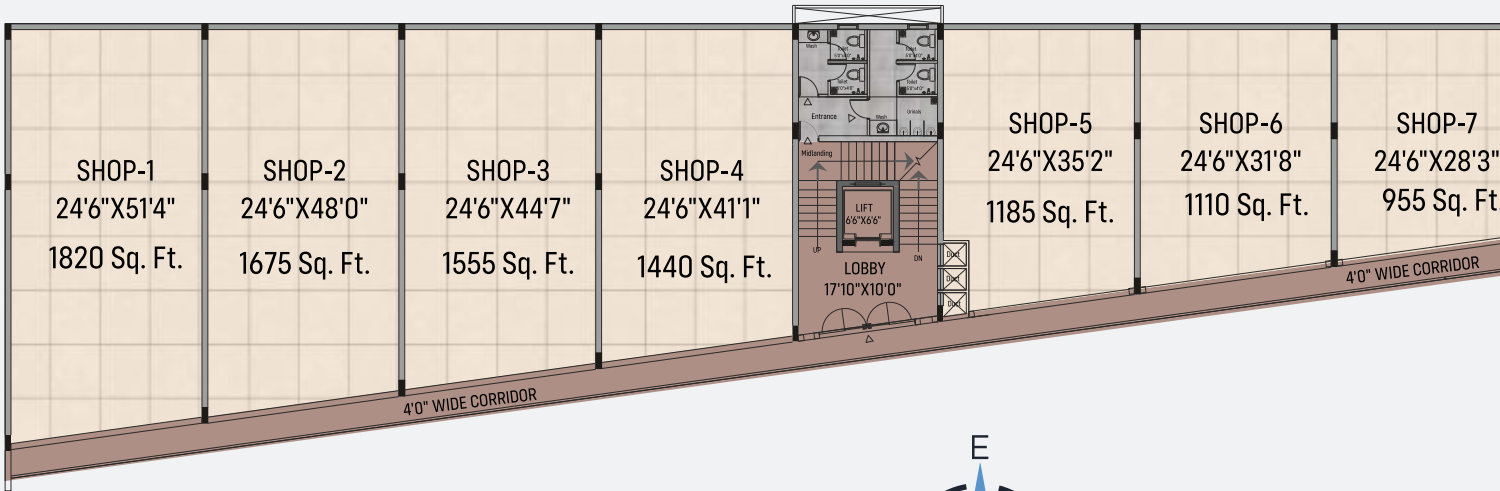

First Floor Plan

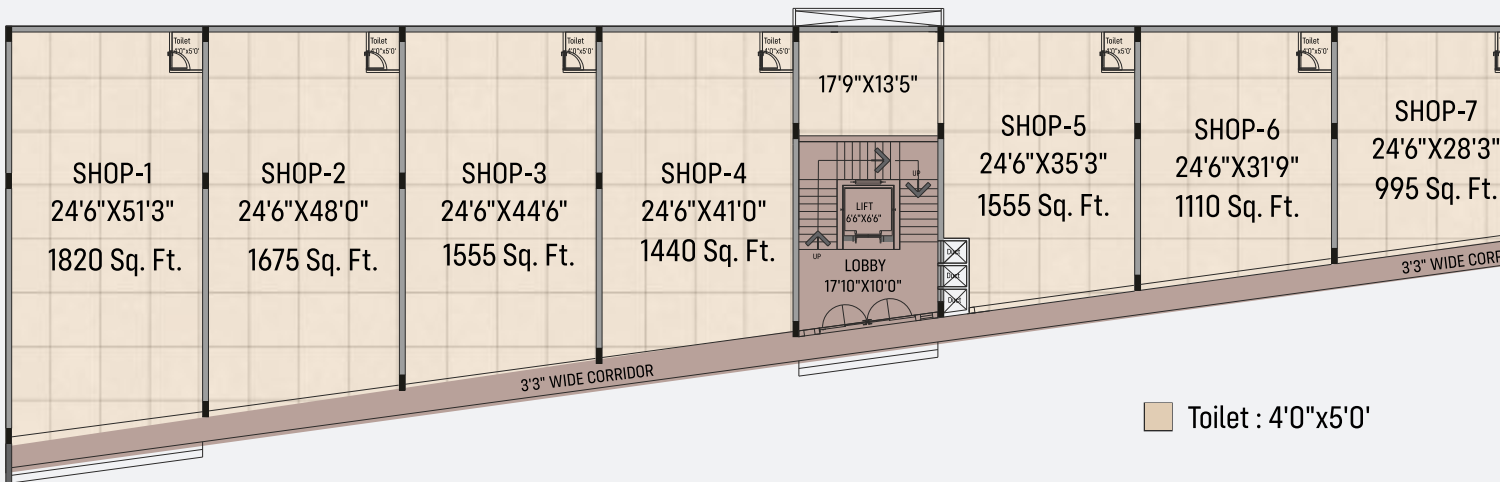

Ground Floor Plan



Rohan Avenue lies foundation on NH 66 at Surathkal that connects Mangaluru to Mumbai, Udupi, Kochi & Panjim.

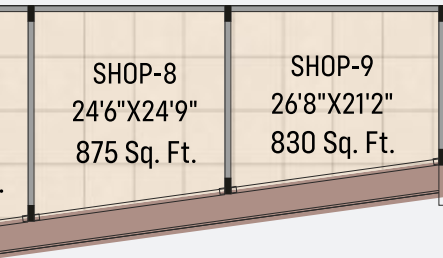

SHOP-F1	1820 Sq. Ft.
SHOP-F2	1675 Sq. Ft.
SHOP-F3	1555 Sq. Ft.
SHOP-F4	1440 Sq. Ft.
SHOP-F5	1185 Sq. Ft.
SHOP-F6	1110 Sq. Ft.
SHOP-F7	955 Sq. Ft.
SHOP-F8	875 Sq. Ft.
SHOP-F9	830 Sq. Ft.

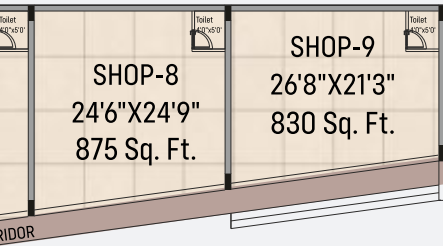

SHOP-G1	1820 Sq. Ft.
SHOP-G2	1675 Sq. Ft.
SHOP-G3	1555 Sq. Ft.
SHOP-G4	1440 Sq. Ft.
SHOP-G5	1555 Sq. Ft.
SHOP-G6	1110 Sq. Ft.
SHOP-G7	995 Sq. Ft.
SHOP-G8	875 Sq. Ft.
SHOP-G9	830 Sq. Ft.

The project is located on the main road of the fast-growing Surthkal area, which bonds Dakshina Kannada's prime cities, Mangalore and Udupi.



2-3 mins drive away from Hotels, Resorts & Leisure



Easy Connectivity Located at Surathkal Junction



Steps away from Surathkal Bus Stand and Railway Station



In close reach to Market, Banks, Hospitals and Surathkal Police Station



2.9 km away from the prestigious NITK and close to various Educational Institutions



2.2 km away from Suratkal Beach & Tourist attractions



# The best plot for a dream home

## Highlights



Plots size :  
5.16 cents and above.



Street lights



Nature friendly

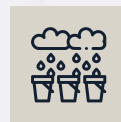

Rain water harvesting.



Concrete roads :  
30 feet wide main road

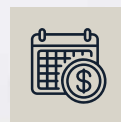

Easy Installments



Underground electric lines.



Loan facilities from Bank.



Underground drainage line



24x7 Security system



## Proximity Table

Surathkal Bus Stand	350 m	Hotel Sai Suraj International	600 m
Surathkal Railway Station	950 m	Mangaluru City Corporation Zonal Office-1	700 m
National Institute of Technology	2.7 km	Govinda Dasa Degree College	850 m
Shrinivas Institute of Medical Sciences	3.9 km	Sacred Heart Church	900 m
MRPL	5.5 km	Krishnapura Mutt	3.0 km
HPCL Mangalore	7.6 km	Eidga Juma Madjid	3.1 km
APMC, Mangalore	9.4 km	Surathkal Lighthouse	3.9 km
Baikampady Industrial area	10.4 km	Honnakatte Junction	7.8 km
Primacy Industries Limited	11.7 km	Ryan International School	8.2 km
Mangalore International Airport	20.6 km	MCF Limited	13.9 km

## Ongoing Projects



ROHAN ESTATE  
Pakshikere, Mangaluru



ROHAN SQUARE  
Capitanio, Mangaluru



ROHAN ESTATE  
Baithurli, Kulshekar, Mangaluru



ROHAN CITY  
Bejai, Mangaluru

## Completed Projects



HIGH CREST  
Kadri Kambla, Mangaluru



ZORION  
Jeppinamogaru, Mangaluru



CITY SQUARE  
M.G. Road, Mangaluru



VICTORIA  
Valencia, Mangaluru



PRIMERO  
Padil, Mangaluru



VENTURA  
Bejai Main Road, Mangaluru



MICASA  
Bejai, Mangaluru



BELLISSIMA  
Mallikatta, Mangaluru



HILL CREST  
Ladyhill, Mangaluru



BIANCA  
Bejai, Mangaluru



INFINITY  
Kankanady, Mangaluru



DAIJIWORLD RESIDENCY  
Bondel, Mangaluru



EXOTICA  
Bendore, Mangaluru



CATALONIA-I  
Kulshekar, Mangaluru



CATALONIA-II  
Kulshekar, Mangaluru



PETERS COTE  
Kankanady, Mangaluru



LUMINUS  
Kulshekar, Mangaluru



SILICONIA  
Kuttar, Mangaluru



ODYSSEY  
Arya Samaj Road, Mangaluru



PLAMA HABITAT  
Kulshekar, Mangaluru



PAM ARCADE  
Kottara, Mangaluru



HIGHGROOVE  
Bejai, Mangaluru



SERENITY  
Bejai, Mangaluru



CONCORD  
Falnir, Mangaluru

### Promoters



**ROHAN**  
CORPORATION<sup>®</sup>

Main Road, Capitanio, Pumpwell  
Mangaluru 575 002  
[rohancorporation.in](http://rohancorporation.in)

Follow us on



For Booking Contact:  
**+91 98454 90100**